

Register your product online

For Singapore Warranty, please scan QR code or visit below website:



<https://www.whirlpool.com.sg/>

For Philippines Warranty, please refer to the separate warranty card.

Whirlpool

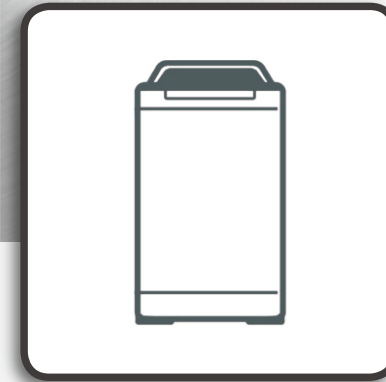

## Health & Safety, Use & Care, Installation Guide

### Models:

VWED1403BG  
VWED1302GG



- Please read this manual carefully before using this machine, and please keep it in a safe place.
- When the washing machine is not in use, the water tap must be turned off and the power cord must be unplugged.
- This machine is manufactured with reusable materials. Please assist in proper disposal or recycling when disposing to protect the environment.
- This machine may be subjected to changes in structure and performance parameters in the future without prior notice.

## Content









Safety Instructions	2~4
Care And Maintenance	4
Installation Instructions	5~7
Product Description	8
Accessories	8
Control Panel	9~10
General Usage	11~12
Cycle Guide	13~14
Duvet Cycle	15
Wash + Airdry Cycle	15
Wool Cycle	16
Functions	16~17
Troubleshooting Guide	18
Non Fault Conditions	19
Specifications	20

## Safety Instructions

- Please read "the manual" carefully before using this appliance.
- This appliance is not intended to be used by persons with insufficient physical, sensory, or mental function (including children), or those who lack experience and knowledge, unless under the supervision or guidance of a person who can ensure their safety.
- In order to avoid any property damages or personal injuries in usage, the matters that must be observed in terms of safety are explained as below:

 <b>Warning</b>	Misoperation may cause "Possibility of death or injury".
 <b>Attention</b>	Misoperation may cause "Possibility of injury and damage to items".

		
"Warning or Attention".	"Actions" .	"Attention" .

 <b>Warning</b>	
 <b>Modification is not allowed, non-professional maintenance personnel are prohibited to disassemble and repair the washing machine.</b> <ul style="list-style-type: none"> <li>• Can cause fire, electric shock, or injury.</li> <li>• Please contact your dealer or After-sales Service in case of failure.</li> </ul>	 <b>Do not bend, pull, or twist the power cord excessively.</b> <ul style="list-style-type: none"> <li>• It may cause damage to the power cord and may lead to fire or electric shock.</li> </ul>
 <b>During maintenance, be sure to unplug the power cord from the socket. In addition, do not plug or unplug the power cord when your hands are wet.</b> <ul style="list-style-type: none"> <li>• It may cause electric shock and injury.</li> </ul>	 <b>Do not use voltage or frequency other than the marked specifications.</b> <ul style="list-style-type: none"> <li>• It may cause damage, fire and electric shock.</li> </ul>
 <b>Do not use the power cord and plug when they are damaged or loose.</b> <ul style="list-style-type: none"> <li>• Can cause electric shock, short circuit, injury or fire.</li> </ul>	 <b>Dusts and other dirt on the power cord and plug shall be removed regularly.</b> <ul style="list-style-type: none"> <li>• If dust accumulates on the power cord and plug, it can cause fire due to poor insulation caused by moisture.</li> </ul>
 <b>Do not use the washing machine for other purposes.</b> <ul style="list-style-type: none"> <li>• The washing machine shall not be used for any purposes other than washing clothes that can be washed in accordance with the instructions to avoid damage to the washing machine or other possible danger.</li> </ul>	 <b>Do not place on uneven ground.</b> <ul style="list-style-type: none"> <li>• Otherwise machine will be easy to fall and move, causing injuries and damages to the washing machine.</li> </ul>

## Safety Instructions

### ⚠ Warning

**When the washing machine is running, do not reach into the wash/spin tub.**

- If your hand touches the tub, it may cause injury.
- During spinning, if the tub does not stop rotating within 15 seconds of opening the door, please immediately turn off the power and contact your dealer or After-sales Service.



Do not touch

**Do not wash clothing that has been exposed to volatile solvents.**

- Do not wash clothing stained with gasoline, kerosene, thinner, etc. This may cause fire or explosion.



Forbidden

**Must be grounded properly.**

- The socket should be well grounded.
- In order to prevent leakage accidents.



The socket should be well grounded

**Avoid installation in wet and rainy places.**

- The bad insulation of electrical appliances will cause electric leakage or fault.



Forbidden

**Children should be supervised to ensure that they do not play with the appliance.**

- Serious injuries may occur if children accidentally fall into the wash/spin tub.



Forbidden

**Sockets other than specified rating is not allowed to be used.**

- It may cause risk of damage, fire and electric shock.
- Please use sockets above 10A alone, do not use extension sockets or share power with other appliances.



Forbidden

**Plugging and unplugging of the power cord.**

- When plugging or unplugging the power cord hold the insulating part to apply force. Do not touch the metal piece of the plug or apply force to the wire end to avoid electric shock or pull off of inner wire of the power cord.
- Be sure to unplug the power cord before moving the washing machine.



Forbidden

**Keep away from fire.**

- Keep away from fireworks, and do not place lighted candles, cigarettes, mosquito coils and kettles on washing machines. This is the main cause of fire or deformation.



Forbidden

**Protection of the power cord.**

- Please check the power cord is not frayed before connecting and don't use extension cord. If the supply cord is damaged, it must be replaced by the manufacturer, it's service agent or similarly qualified person in order to avoid a hazard. Please contact your dealer or After-sales Service.



Forbidden

**Modification or self repair is not allowed.**

- Except for the professional from the manufacturer, it is forbidden to self modify or repair it to avoid the danger of fire or electric shock.
- The new hose-sets supplied with the appliance are to be used and that old hose-sets should not be reused.



Disassembling Forbidden

**Waterproof or non-absorbent laundry should not be washed in the washing machine.**

- To avoid abnormal vibration when washing or spinning. (Eg: raincoat, car cover)



Forbidden

**Be careful when visiting the washing machine.**

- Especially for people with long hair, please be careful not to drop your hair into the gaps to avoid risk of hair being trapped.



Attention

## Safety Instructions

### ⚠ Attention

**Watch out for spills of laundry.**

- Do not wash clothing that is water-resistant to avoid damage caused by laundry overflow during spinning.



Attention

**Do not wash the parts of the washing machine directly with water.**

- To avoid the risk of electric shock due to poor insulation.



Forbidden

**Do not connect to hot water supply!**

- Hot water can deform plastic parts, it is the cause of malfunction.



Forbidden

**Please do not stand on or put weight on the washing machine.**

- To avoid danger caused by deformation or damage of components.



Forbidden

**Do not attempt to touch the internal moving parts while the washing machine is running.**

- To avoid danger of injury.



Do not touch

**When the washing machine is not in use**

- The water tap should be closed to prevent the water inlet hose from being damaged or falling off, resulting in a water leakage accident.
- The power cord should be unplugged to prevent fire or other accidents.



Unplug the Power cord

**Please do not plug or unplug the power cord when your hands are wet.**

- To avoid the danger of electric shock.



Wet and Forbidden

**Special attention:** Do not put your fingers or any items near the gap between door lid and the top part of cabinet.

- To avoid danger of injury or causing malfunction.



Attention

## Care And Maintenance

### Clean washing machine

Use soft clothing to wipe off the water or dirt on the surface of the washer.

- Do not spray water directly to the washer body.
- Detergent, propellant and other chemicals are not allowed to use to avoid the damages on the surface.



### Clean the water inlet Valve

(Suggest clean it every 6 months)

After long-term use, The water inlet mesh bag may be blocked with dirt, please load off the water inlet hose, take out the water inlet mesh bag from the water inlet valve, clean the mesh bag, then assemble the mesh bag in the valve and load the water inlet hose.



Water Inlet

### Clean Hose Filter

(Suggest clean it every 6 months)

1. Pull the water inlet hose out.
2. Turn off the revolver according to the figure shown.
3. Load off the "Universal" Hose Joint filter and clean the dirt with a toothbrush.
4. Install the clean "Universal" Hose Joint filter to revolver and water inlet hose.

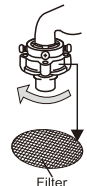

Filter

### Clean lint filter

(Suggest clean it after each wash cycle)

1. Take out the lint filter.
  2. Pull out the lints and wash the lint filter in the water.
  3. Install the Filter ( fix the frame claw to the groove below).
- ( Lint Filter is easily destroyed parts).



## Installation Instructions

### Transportation

At least two people are needed to carry the machine. One person on one side carries the cabinet handles. Before handling or tilting the machine, secure the top cover of the washing machine is closed to avoid danger (such as using tape to close it).

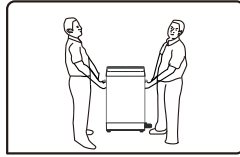

### Installation of Bottom Cover

1. Take out the bottom cover on the washing machine surface protection rack and the screws in accessories bag.
  2. Tilt the washing machine backwards and slowly lay it down on the cushion.
- Note: Before tilting the machine, ensure that the top cover of the washing machine is closed (such as using tape).
3. Push the bottom cover straight into the base slot until it is seated in position.
  4. Fix the bottom cover to the base with screws.
  5. Lift up the washing machine gently and make it stand steady.

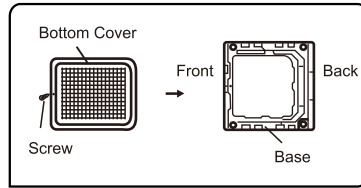

**Note:** Please be sure to install the bottom cover in place before using.

### Location of the washing machine

1. Choose a dry place out of sunlight to place the washing machine.
2. Place the washing machine on a solid, stable floor.
3. The floor where the washing machine is installed should have a floor drain, and the floor drain should be unobstructed. At the same time, the floor drain should be flat with or slightly lower than the surface on which the washing machine is installed to prevent water leakage of the washing machine and cause harm.
4. Make the washing machine stand as stable as possible. If necessary, level the washing machine by adjusting the adjustable feet of the washing machine in the order shown. The maximum allowable inclination of the washing machine placement surface is 2°.
5. Minimum installation distance from the wall or installation cabinet is 10cm.

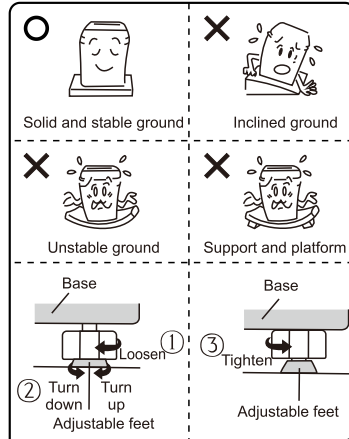

**Note:**

- When the washing machine is placed on the floor or a flexible support, vibration of the washing machine may be caused.
- Do not place carpets, etc. under the bottom of the washing machine to avoid blocking the bottom area.

### Selection of Water Tap

Water Tap type: (the opening of the water tap should be flat)

Type A: Most suitable.

Type B: The water tap length must be greater than 16mm, otherwise the universal joint cannot be installed.

Type C: Water leakage may occur in the area as shown in the figure.

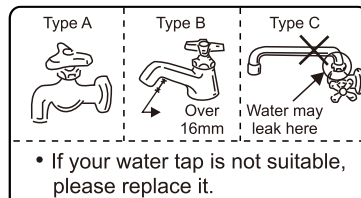

**Note:**

1. When installing the washing machine, be sure to remove the pedestal and bracket used for transportation at the bottom of the washing machine, otherwise it will not be usable.
2. During installation or initial use, there will be a small amount of water flowing out of the drain hose, which is the residual water left during the routine inspection of the factory.
3. After using the washing machine, please unplug the power cord and turn off the water tap to prevent fire and water leakage.

## Installation Instructions

### Installation of Universal Joint

1. Hold the universal joint on one hand and press the locking lever on one hand to separate the universal joint from the water inlet hose.
2. Adjust the 4 screws on the universal joint evenly, so that the 2 screws on the wall side can fully make contact with the outer part of the water tap first.
3. Put the universal joint vertically on the water tap, make the inner seal ring close to the opening of the water tap, and tighten the 4 screws with a screwdriver.
4. Remove the seal from the universal joint and tighten the universal joint.

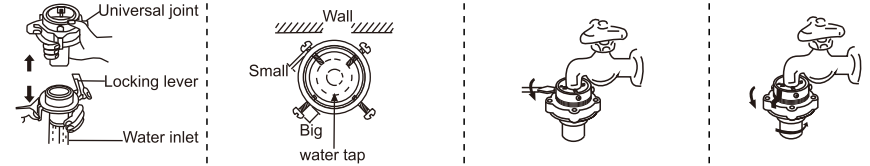

### Connection of water inlet hose

1. Connect the water inlet hose to the universal joint.
2. Align the inlet hose port with the inlet valve port, and turn the tightening nut on the inlet hose clockwise until it stops.
3. Check whether the water inlet hose is securely connected.
  - Pull the water inlet hose downward to confirm that the water inlet hose is connected to the universal joint reliably, then slowly open the water tap to check water leakage. If water leaks, turn off the water tap and reinstall it.
  - After long-term use, the universal connector may become loose. In this case, please reinstall it.
  - Turn off the water tap when the machine is not in use.

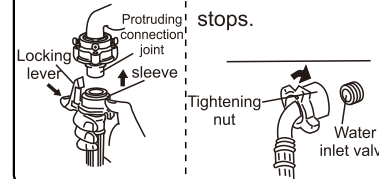

### Removing the water inlet hose

1. Turn off the water tap.
2. Press the "Power" button to turn ON the power, and press the "Start / Pause" button.
3. Turn off the power after 15 seconds.
4. Press down on the locking lever and sleeve with finger and pull them downward to remove the water inlet hose.
5. Turn the water inlet hose on the water inlet valve counterclockwise until the water inlet hose is removed.

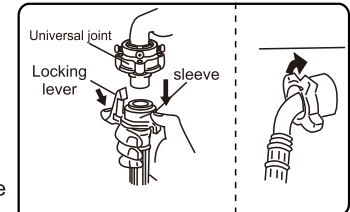

### Connection of drain hose

1. Connect the drain hose to the drainage outlet and secure it with the hose circlip. As shown on the right:

**Note:** Be sure to use the new water inlet hose in the accessories bag. The old water inlet hose cannot be reused.

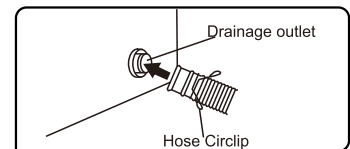

## Installation Instructions

### Change the direction of the drain hose

The drain hose can be changed from the right to the left according to the needs in use.

- The power cord should be unplugged when replacing.
- Gloves should be worn to prevent hand scratches.

1. Remove the drain cover on the left side.
2. Tilt the washing machine backwards on a soft cushion.  
Note: Before tilting the machine, ensure that the top cover of the washing machine is closed (such as using tape).
3. Loosen the hose circlip and disconnect the drain hose from the drain valve.
4. Push the connector of the drain port and pull the drain hose out of the washing machine from the right drain port.
5. Insert the drain hose from the drain port on the left, and tighten the joint.
6. Connect the drain hose with the drain valve and fix it with a hose circlip.
7. Install the drain cover on the right side.
8. Lift up the washing machine gently and make it stand steady.

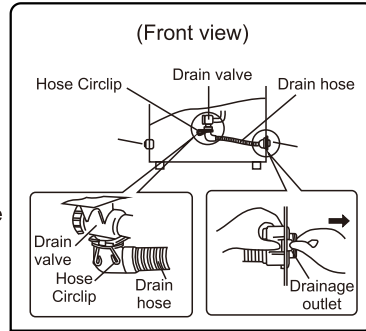

### Extension of the drain hose

When the length of the drain hose is not long enough, please purchase an extension hose from your dealer or After-sales Service to connect it.

Extension of the drain hose	Extension height	Extension length
There are steps in between	Within 15cm	Within 1m
There are no steps in between	—	Within 3m

### Drain hose hook installation

1. Before installing the drain hose hook, please adjust the direction of the drain hose as needed.
2. Paste the hook of the drain hose on the surface frame or the box on the side where the drain hose of the washing machine is located.
3. Please hang up the drain hose when the washing machine is not in use.

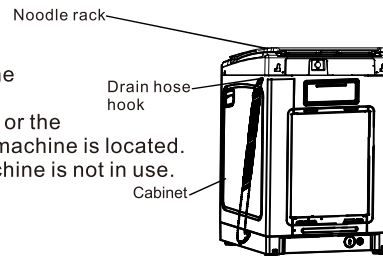

### Using the rollers

The washing machine is equipped with two rollers at the back that you can use to move the machine more easily. Tilt the washing machine by about 30 degrees and push forward, or pull backward, while holding the machine securely on both sides with your hands, as illustrated below.

Do not move the machine on the rollers on uneven ground, which can damage the rollers.

**CAUTION: Take care of your back!** Do not tilt the washing machine too much, which could cause injury.

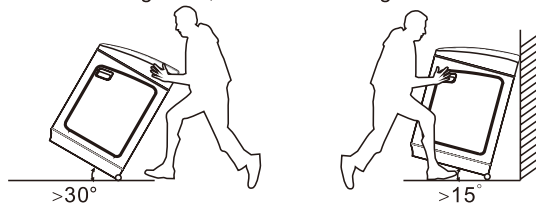

## Product Description

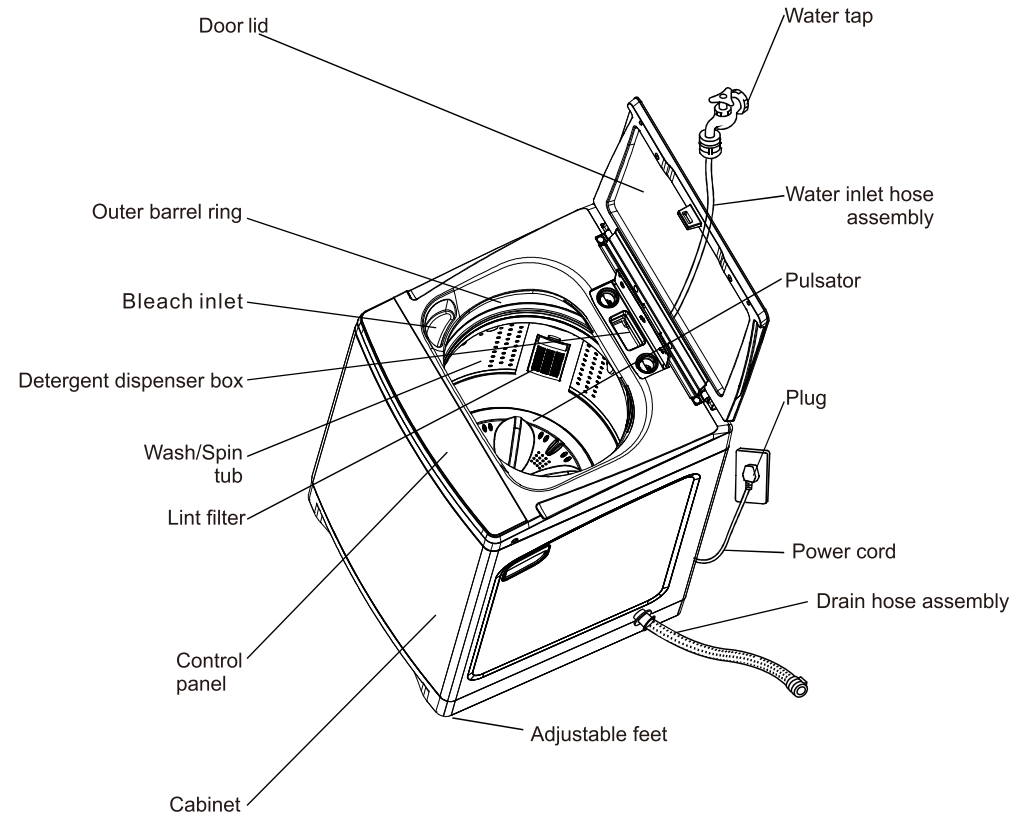

Picture for reference only, please refer to the actual product.

## Accessories

Instruction Manual	Drain hose assembly (1pcs)	Water inlet hose assembly (1pcs)	Bottom cover (1pcs)	Screw (One pc.)	Drain hose hook (1pcs)

## Control Panel

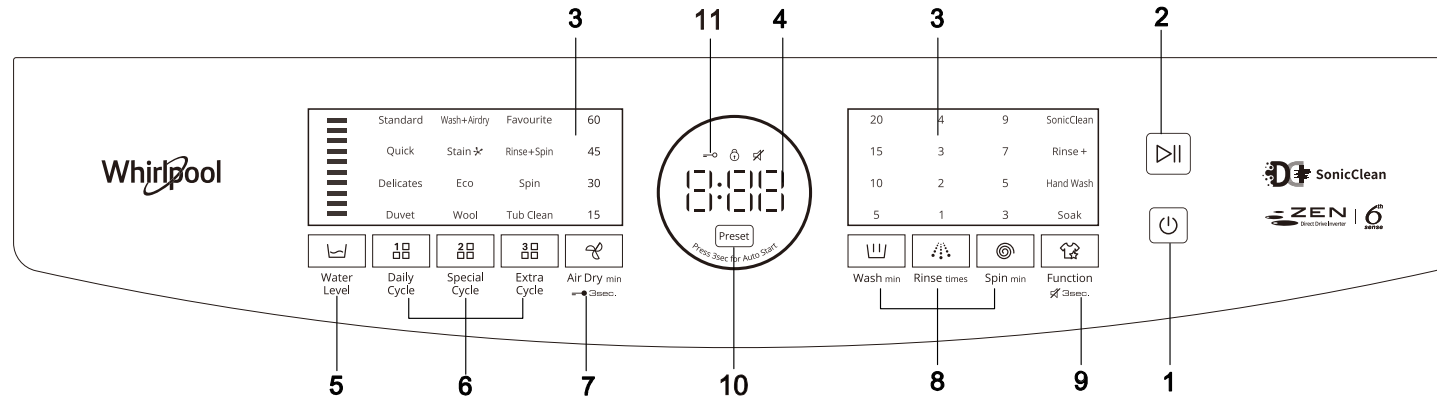

\*Note: Above panel for reference only, please refer to actual product

### 1. Power ON/OFF Button

- Press this button to switch on the washing machine. To switch off the power, press it again. If idle for 10 minutes after machine is turned on, the power will be automatically cut off. After washing program finishes, the power will be cut off automatically after 5 seconds.

### 2. "Start/Pause" Button

- Press this button to start the wash cycle. Press once to pause the operation, to resume, press the same button again.

### 3. Setting display window

- When the power is turned on, it displays settings such as wash cycles, washing time, rinse times, spinning time etc.
- During the setting process, the item you selected will be displayed.

### 4. Digital display window

- The remaining time is displayed during operation. Example: 20 minutes remaining. ----- 0:20
  - If preset function is selected, it shows when the cycle is set to be completed. Example: Complete in 2 hours:----- 2H
  - When the child lock function is set, the child lock indicator lights up. ----- ●
  - When an error occurs, a fault code is displayed. Example: No water intake: ----- E1
- Note: Fault code with 4 digits(e.g E901) will be displayed alternatively.
- After the washing machine has started, the door lock will be activated and the door lock indicator door lock will light up. ----- Ⓐ
  - After started for one minute, if there is no operation, the display will automatically turn off, and all buttons will be automatically locked (except for the "Power On / Off" button). Press and hold any key to unlock.

### 5. Water level Button

- Press the button to select the suitable washing water level (1-10, by sliding the water level gear).
- Not applicable for some cycles.
- The water level can be set after operation started.

### 6. "Cycle" Buttons

You can select the desired wash cycle by pressing one of the "Cycle" button.

### 7. "Air Dry" Button

You can freely choose the corresponding air-drying time (15-60mins) according to your needs.

### 8. "Option" Buttons

You can freely set the washing time, rinse times, spinning time according to your needs.

### 9. "Function" Button

You can freely choose the functions Soak, Hand Wash, Rinse+ and SonicClean according to your needs.

### 10. Preset Button

- After power on, press the "preset" button to set the delay function, and preset the time from the start to the end of program.
- Delay time can be set from 1-24 hours.
- In shutdown mode press and hold the button for 3 seconds to auto start a predefined cycle.

### 11. Child lock indicator

- After the child lock function is turned on, the child lock indicator lights up. All buttons will not respond except for the "Power On / Off" button.

## General Usage

### 1.Preparation

- ① Connect and lay down the drain hose.
- ② Connect the water inlet hose to the water tap.
  - Before turning on the water tap, make sure the screws of the universal joint are tightened. If the screws are loose, it may cause water leakage.
- ③ Plug the power cord into a power socket.
- ④ Put in laundry.

### 2.Add detergent in the detergent box or directly into the tub.

#### Detergent box

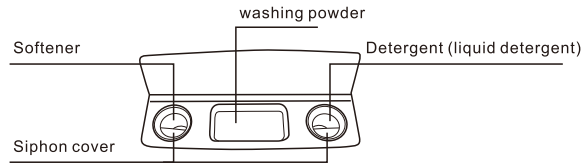

Before washing, the liquid detergent, washing powder and softener should be added into the corresponding compartment as per needed.

During the washing process, it will be automatically added to the tub.

Note the following instructions:

#### • Washing powder compartment:

- ① Please add a proper amount of washing powder according to the loading, the selected water level, the degree of soiling of the laundry and the instruction manual of the washing powder you choose;
- ② If delay function is set, it is recommended to put the washing powder directly into the compartment in advance;
- ③ It is recommended not to use high foaming washing powder, so as keep good washing effect or to avoid foaming overflow;
- ④ Washing powder with bad quality may coagulate in the compartment, please clean it periodically .

- **Liquid detergent compartment:** Pour the liquid detergent here, and do not exceed the MAX line.

- **Softener compartment:** Pour the softener here, and do not exceed the MAX line.

\* Note: The siphon cover cannot be removed during washing.

### 3.Press the "Power On/Off" button to turn on the power and select the desired cycle or function.

### 4.Close the lid and press the "Start/Pause" button.

- Sensor will automatically detects the amount of cloth.
- If the lid of the washing machine is not closed, the washing machine will not be able to complete the washing process normally and there will be alarm alert.

## General Usage

### How to use laundry detergent when select preset function

- Washing powder can be placed directly in the washing powder dispenser or wrapped in a towel and placed directly in the tub.
- Liquid detergent and bleach can be poured directly into the holes on top frame, but not directly on the clothing, otherwise it may cause clothing color to fade.
- Dilute the softener two times and pour into the softener dispenser box.
- Please do not use saponin tablets, because it does not dissolve easily and will affect washing effect.

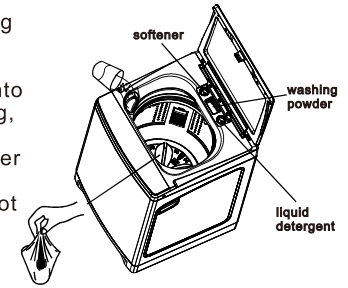

### Laundry Detergent and Water Consumption

Water level									
Powder laundry detergent dosage(g)	20-30	30-35	35-40	40-50	50-60				
Other types of laundry detergent	Use according to the corresponding laundry detergent instructions								

If the amount of detergent is too much, there may be residues, while if it is too little, the laundry may not be clean.

### Introduction of two rinsing conditions

#### 1. Rinse with retained water (usual method)

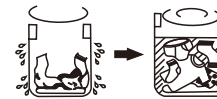

After spinning is completed, the water will flow into the tub, once reach set water level, rinsing process will starts.

#### 2. Rinse with water overflowing (When there is a lot of detergent)

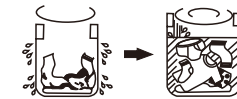

After spinning, water flow from inlets to the setting level. Then machine starts rinsing while water continue to flow from inlet to better dissolve detergent residues, the detergent residue will then overflow through outlet hose and drain into sewer.

## Cycle Guide

Cycle	Description	Recommended maximum washing capacity	Approximate duration/min	Water Level	Standard setting			Function					
					washing / min	rinsing / times	spinning / min	Preset	Child Lock	Soak	SonicClean	Rinse+	Hand wash
<b>Standard</b>	Suitable for washing cotton and linen fabrics	Rated Capacity	47-68	Default: automatic Range:1-10	6-15	2	7	●	●	●	●	●	●
<b>Quick</b>	Suitable for quick washing of lightly soiled clothes	≤3kg	27-35	Default: automatic Range:1-10	5	1	3	●	●	○	●	●	○
<b>Delicates</b>	Suitable for gentle washing of fine fabrics	≤3kg	34-46	Default: 7 Range:3-10	5	2	3	●	●	○	●	●	○
<b>Duvet</b>	Suitable for washing large household textiles	Rated Capacity 70%	80-88	Default: 10 Range:5-10	15	3	9	●	●	●	●	●	○
<b>Wash + Airdry</b>	It is suitable for fast washing and air drying of a small loading of lightly soiled clothes, reducing the amount of water remaining in the clothes and saving your time for line drying	≤3kg	54-62	Default: automatic Range:1-10	5	1	30	●	●	○	●	○	○
<b>Stain</b> ✶	Cold water stain removal cycle	≤3kg	61-73	Default: automatic Range:1-10	20	2	7	●	●	●	●	●	○
<b>Wool</b>	Suitable for washing machine washable wool clothing	≤3kg	34-46	Default: 7 Range:3-10	5	2	3	●	●	○	●	●	○
<b>Eco</b>	It is suitable for washing cotton and linen fabrics, it is the most efficient in terms of energy and water consumption	Rated Capacity	61-73	Default: automatic Range:1-10	20	2	7	●	●	●	●	●	○
<b>Favourite</b>	Suitable for the washing of cotton and linen fabrics, the set parameters (washing time, rinse times, spinning time) will be memorized	Rated Capacity	47-68	Default: automatic Range:1-10	6-15	2	7	●	●	●	●	●	●
<b>Rinse + Spin</b>	For clothing that only needs to be rinsed and spinned	Rated Capacity 70%	24-28	Default:10 Range:1-10	—	1	7	●	●	○	○	○	○
<b>Spin</b>	For clothing that only needs to be spinned	Rated Capacity 70%	10	—	—	—	7	●	●	○	○	○	○
<b>Tub clean</b>	The inner tub is cleaned by washing it for a long time	—	115	Default: 10	85	1	3	●	●	○	●	○	○
<b>Air dry</b>	Use it independently after washing, reduce the amount of residual water and save your time for line drying	3kg	15-30-45-60	—	—	—	—	●	●	○	○	○	○

•Based on the water pressure or the type of loading, etc., the actual washing time is slightly different from the time shown in the above table.

•If the load is not placed according to the recommended washing capacity, the expected washing effect may not be achieved.

•If you choose different washing time, rinse times, spinning time parameters and function options, the displayed time will be different.

**Note(VWED1302GG):** The programme used for the evaluation under the mandatory Water Efficiency Labelling Scheme(WELS) and the recommended Washing Programme for normally soiled clothes at rated load capacity is as follows: Standard program, select water level "10", other parameters are not adjusted by default.

●	None by default, selectable
○	None by default, not selectable



## Duvet Cycle

- When using this cycle, the water level is automatically set to level 10, and you can set the appropriate water level within the allowable range according to your needs.

**How to use** (Take the washing of blankets as an example)

1. Open the washing machine lid and press the "Power On / Off" button.
2. Select "Duvet" cycle, the cycle light is on.
3. Add detergent in the detergent box or directly into the tub.
4. Add blanket into the washing machine.

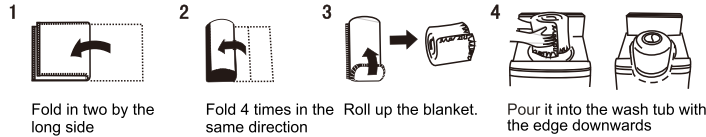

5. Close the lid.
  - If the lid of the washing machine is not closed, the washing machine will not be able to complete the washing process normally and there will be an alarm alert.
6. Press the "Start/Pause" button. (If necessary, the water level can be adjusted manually)
  - After the washing is completed, the buzzer will ring and the power will be cut off automatically.
  - After washing, turn off the water tap and clean the filter.
7. Cycle finished.  
Take out the blanket and hang it up for line drying.

**NOTE:**

- Pre-wash soiled parts by hand.
- Do not use too much detergents.
- Stains are effectively removed with warm water.
- During the washing process, if part of the blanket is spill outside water, press the "Start/Pause" button, the washing machine will stop running temporarily, press the part back in, and press the "Start/Pause" button again to continue washing.
- This cycle is not applicable for down jackets.

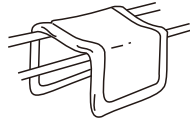

## Wash + Airdry Cycle

- It is suitable for quickly air drying lightly soiled clothes using fresh air blown in, reducing the amount of residual water in the clothes and saving your time for line drying.
- The spinning time is fixed as 30 minutes and cannot be adjusted.
- The washing capacity should be below 3kg.

**How to use**

1. Open the washing machine lid and press the "Power On / Off" button.
2. Select "Wash+Airdry" cycle, the cycle light is on.
3. Add detergent in the detergent box or directly into the tub.
4. Add laundry into the washing machine.
5. Close the lid.
  - If the lid of the washing machine is not closed, the washing machine will not be able to complete the washing process normally and there will be an alarm alert.
6. Press the "Start/Pause" button. (If necessary, the water level can be adjusted manually)
  - After the washing is completed, the buzzer will ring and the power will be cut off automatically.
  - After washing, turn off the water tap and clean the filter.

## Wool Cycle

- Please check the washing label on clothes before washing.
- When using this cycle, the water level is automatically set to level 7, and you can set the appropriate water level within the allowable range according to your needs.

**How to use**

1. Open the washing machine lid and press the "Power On / Off" button.
2. Select "Wool" cycle, the cycle light is on.
3. Add detergent in the detergent box or directly into the tub.
4. Add laundry into the washing machine.
5. Close the lid.
  - If the lid of the washing machine is not closed, the washing machine will not be able to complete the washing process normally and there will be an alarm alert.
6. Press the "Start/Pause" button. (If necessary, the water level can be adjusted manually)
  - After the washing is completed, the buzzer will ring and the power will be cut off automatically.
  - After washing, turn off the water tap and clean the filter.

**Note**

- Washing capacity should be below 3kg.
- After the program is finished remove clothes from the tub and lay flat to dry them, to prevent odor and wrinkles.
- Wash white or light colored clothing separately from dark colored clothing.
- The use of special detergent for wool is recommended for a better washing effect.

## Functions

### Preset function

- The delay time is the time from the start to the end of cycle.
- Before setting the delay time, first turn on the water tap, lay down the drain hose, and check whether the universal joint is tightened to prevent water leakage.

**How to use**

1. Open the lid and press the "Power On / Off" button.
2. Add laundry into the washing machine.
3. Select the appropriate cycle, function and water level as per need.
4. Press the "Preset" button to set the delay time.
  - Delay time can be set from 1-24 hours.
5. Add detergent and cover the lid.
  - When you set a delay time, add detergent, washing powder, and softener into the corresponding detergent compartment.
6. Press the "Start/Pause" button.
  - After about one minute, all lights except the cycle light are off. (If the child lock function is set, the child lock light is on.)
  - To view the selected cycle, press any button except the "Power On/Off" button. The selected cycle will displayed for 5 seconds.
  - To change the selected cycle, turn off "Power On/Off" and restart the settings.
  - The function will be cancelled after unplugging power cord or power failure.

## Functions

### Child lock function

This function prevents improper use (by children). After the child lock function is turned on, all other buttons will not respond except the "Power On/Off" button.

- Setting child lock function: Press the "Power On/Off" button. After turning on the power, press and hold the "Air Dry" button for 3 seconds until you hear a beep sound, the child lock function is activated. To cancel repeat the above steps.

### Mute function

- Select the Mute function to cancel the beep sound in operations.
- Fault code alarm will not be cancelled when Mute function is set.

### SonicClean function

- Select the "SonicClean" function to turn on the ultrasonic function during the washing process, and the in-built generator will form fine bubbles to enhance the washing effect, remove stains, better dissolve and hence saving the use of washing powder.
- Some cycles cannot set this function.

### Soak function

- Select the soaking function to allow the detergent to fully dissolve and penetrate into the clothes, reducing the adhesion of stains to the clothes, and enhance cleaning effect.
- After selecting the soaking function, soaking phase will be added before main wash (quick, delicates, wash+air dry, wool, tub clean, rinse+spin, spin, air dry cycles do not have this function).
- The soaking time is 20 minutes. During dynamic soaking, the first 5 minutes is 3 minutes of washing and 2 minutes of set (no movement), and then 1 minute of washing and 4 minutes of set each time.

### Hand wash function

- Select the "Hand wash" function, it works by the imitation of hand wash by water flow for enhanced washing performances.
- Some cycles cannot set this function.

### Rinse+ function

- Select the "Rinse+" function to change the last rinse to running fresh water instead of normal rinsing, reducing detergent residue.
- Some cycles cannot set this function.

### Change the settings of a running cycle

- After a cycle started, the parameters that have not been run can be changed at any time without having to turn off the power to set again.
- This function is limited to non-running parameters. For example, during the washing phase, you could press the "Rinse" button to set the number of rinse times.

## Troubleshooting Guide

When the following problems occur, the microcomputer will detect the abnormal state and issue an electronic buzzer, and the digital window will display the status as shown in the table below.

### Note:

After checking each item and removing the fault, press the "Start / Pause" button, the fault code should be cleared, and the washing machine will continue to run. If it is still abnormal, please unplug the power plug and contact After-sales Service as soon as possible.

Failure type	Fault code	Reason
Not working at all		<ul style="list-style-type: none"> <li>• Whether the power is connected?</li> <li>• Whether the "Start / Pause" button is pressed?</li> <li>• Whether the preset function has been set?</li> <li>• Whether the fuse or current breaker of the power supply intact?</li> <li>• Whether there is a power outage?</li> </ul>
No water intake or litter water inflow	<i>E1</i>	<ul style="list-style-type: none"> <li>• Whether the water tap is turned on?</li> <li>• Whether the water supply is cut off?</li> <li>• Whether the water inlet hose and water inlet valve filter is blocked?</li> <li>• Whether the water inlet hose of the washing machine is frozen?</li> <li>• Whether the water pressure too low and the water intake time is too long?</li> </ul>
Drainage failure	<i>E2</i>	<ul style="list-style-type: none"> <li>• Whether the drain hose is laid down?</li> <li>• Whether the drain outlet is too high (above 15cm)?</li> <li>• Whether the drain outlet is blocked?</li> </ul>
Not Spin	<i>E3</i>	<ul style="list-style-type: none"> <li>• Whether the laundry is leaning to the side of the tub?</li> <li>• Whether the washing machine is installed flat?</li> </ul>
	<i>E4</i>	<ul style="list-style-type: none"> <li>• Whether the washing lid is open?</li> </ul>
Others	<i>EA Eb EC</i>	<ul style="list-style-type: none"> <li>• Please press the "Power On/Off" button to turn off the power, unplug the power cord, and contact After-sales Service as soon as possible.</li> </ul>
	<i>E901 E902 E920 etc.</i>	
	<i>Ed</i>	

## None Fault Conditions

- 1.Sometimes there are water intake during washing or rinsing. This is the automatic water replenishment due to a drop of water level.
- 2.At the beginning of spinning, the washing machine tub stops and rotates from time to time. This is an intermittent process designed to achieve better performance.
- 3.When rinsing with water overflowing, water may not drain due to low water level or water pressure.
- 4.Water intake and rinsing sometimes occurs during spinning process, this is due to the lean-correction of the clothes performed automatically during the dehydration.
- 5.During the spinning process , if unbalance happened , in order to prevent water and electricity waste, the washing machine will attempt to auto-correct for two times, and will display E3 fault code if all attempts failed, requiring manual adjustment of loads before restarting the washing machine.
- 6.After the spinning is over, there is a sound of water remaining. This is the sound of the balance fluid flowing in the balance ring designed to reduce the dehydration vibration.
- 7.If the power is cut off during the operation, then the operation will be continue automatically after power is resumed, in this event, reset it.
- 8.When the washer lid left open for more than 10 minutes, the water will automatically drain and wash program will be stopped. Please set the program again.

## Specifications

Model no.	VWED1403BG	VWED1302GG
Rated washing capacity	14kg	13kg
Rated spin capacity	14kg	13kg
Rated voltage and frequency	230V~60Hz	220-240V~50Hz
Rated Power	530W	530W
Net weight	47kg	47kg
Water pressure	0.03~0.8MPa	0.03~0.8MPa
Net Dimensions	601Wx626Dx1010Hmm	601Wx626Dx1010Hmm